

Thermoplastic SUCTP 200 Series

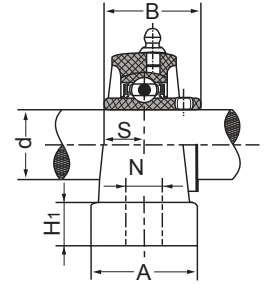
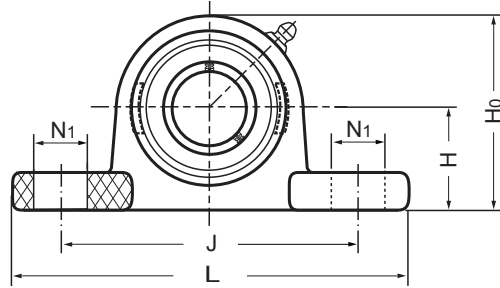
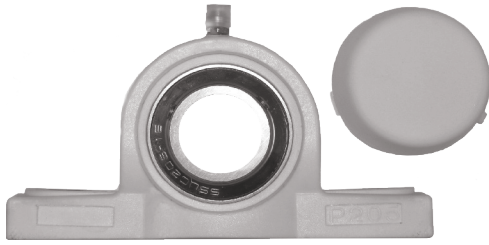

Unit No.	Shaft Diameter (inch / mm)	Dimensions (inch / mm)										Bolt Size (inch / mm)	Bearing No.	Housing No.	Mass	
		d	H	L	J	A	N	N1	H1	H0	B				S	kg
SUCTP 201 201-8 202 202-10 203 204-12 204	12 mm 1/2 15 mm 5/8 17 mm 3/4 20 mm	1-5/16 33.3	5 127	3-3/4 95.3	1-1/2 38	7/16 11	9/16 14	9/16 14.2	2-37/64 65.5	1.22 31.0	1/2 12.7	3/8 M10	SUC 201 201-8 202 202-10 203 204-12 204	TP 204	0.29	0.63
SUCTP 205-14 205-15 205 205-16	7/8 15/16 25 mm 1	1-7/16 36.5	5-1/2 140	4-1/8 105	1-1/2 38	7/16 11	9/16 14	37/64 14.5	2-51/64 71	1-11/32 34.1	9/16 14.3	3/8 M10	SUC 205-14 205-15 205 205-16	TP 205	0.34	0.74
SUCTP 206-18 206 206-19 206-20	1-1/8 30 mm 1-3/16 1-1/4	1-11/16 42.9	6-3/8 162	4-11/16 119	1-13/16 46	9/16 14	45/64 18	45/64 17.8	3-19/64 84	1-1/2 38.1	5/8 15.9	1/2 M12	SUC 206-18 206 206-19 206-20	TP 206	0.54	1.18
SUCTP 207-20 207-21 207-22 207 207-23	1-1/4 1-5/16 1-3/8 35 mm 1-7/16	1-7/8 47.6	6-39/64 168	5 127	1-57/64 48	9/16 14	45/64 18	45/64 18	3-23/32 94.5	1-11/16 42.9	11/16 17.5	1/2 M12	SUC 207-20 207-21 207-22 207 207-23	TP 207	0.78	1.71
SUCTP 208-24 208-25 208	1-1/2 1-9/16 40 mm	1-15/16 49.2	7-1/4 184	5-25/64 137	2-1/8 54	9/16 14	49/64 19.8	49/64 19.5	3-57/64 99	1-15/16 49.2	3/4 19	1/2 M12	SUC 208-24 208-25 208	TP 208	0.97	2.14
SUCTP 209-26 209-27 209-28 209	1-5/8 1-11/16 1-3/4 45 mm	2-1/8 54	7-9/16 192	5-3/4 146	2-1/8 54	11/16 17	25/32 20	29/32 23	4-11/64 106	1-15/16 49.2	3/4 19	5/8 M16	SUC 209-26 209-27 209-28 209	TP 209	1.09	2.33
SUCTP 210-30 210-31 210 210-32	1-7/8 1-15/16 50 mm 2	2-1/4 57.2	8-1/8 206	6-1/4 159	2-23/64 60	11/16 17	25/32 20	29/32 23	4-31/64 114	2-1/32 51.6	3/4 19	5/8 M16	SUC 210-30 210-31 210 210-32	TP 210	1.20	2.64