

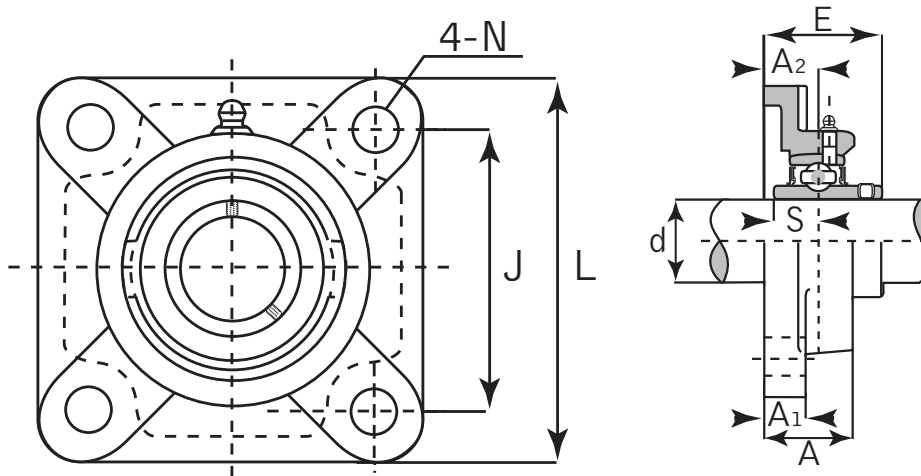

Four-Bolt Holes Flange Unit

Medium Duty



UCFX Set Screw Locking

| Unit No. | Shaft Dia. (inch / mm) | Dimensions (inch / mm) | | | | | | | | Bolt Size | Bearing No. | Housing No. | Weight | |
|------------------------------------|------------------------------------|------------------------|----------------------|----------------------|--------------------|---------------------|--------------------|------------------------|-----------------------|-------------|-----------------------------------|-------------|--------|------|
| | | d | L | J | A | A1 | A2 | N | E | | | | S | kg |
| UCFX 05 05-14 05-15 05-16 | 25 mm 7/8 15/16 1 | 4-1/4 108 | 3-17/64 83 | 1-3/16 30 | 1/2 13 | 45/64 18 | 15/32 12 | 1-19/32 40.2 | 0.6259 15.9 | 3/8 M10 | UCX 05 05-14 05-15 05-16 | FX 05 | 1.00 | 2.20 |
| UCFX 06 06-18 06-19 06-20 | 30 mm 1-1/8 1-3/16 1-1/4 | 4-39/64 117 | 3-5/8 92 | 1-11/32 34 | 9/16 14 | 3/4 19 | 5/8 16 | 1-3/4 44.4 | 0.6889 17.5 | 1/2 M14 | UCX 06 06-18 06-19 06-20 | FX 06 | 1.70 | 3.74 |
| UCFX 07 07-21 07-22 07-23 | 35 mm 1-5/16 1-3/8 1-7/16 | 5-1/8 130 | 4-1/64 102 | 1-1/2 38 | 9/16 14 | 53/64 21 | 5/8 16 | 2-1/64 51.2 | 0.7480 19 | 1/2 M 14 | UCX 07 07-21 07-22 07-23 | FX 07 | 2.10 | 4.62 |
| UCFX 08 08-24 08-25 | 40 mm 1-1/2 1-9/16 | 5-13/32 137 | 4-9/64 105 | 1-9/16 40 | 9/16 14 | 55/64 22 | 3/4 19 | 2-1/64 52.2 | 0.7480 19 | 5/8 M 16 | UCX 08 08-24 08-25 | FX 08 | 2.40 | 5.28 |
| UCFX 09 09-26 09-27 09-28 | 45 mm 1-5/8 1-11/16 1-3/4 | 5-5/8 143 | 4-3/8 111 | 1-9/16 40 | 9/16 14 | 29/32 23 | 3/4 19 | 2-3/16 55.6 | 0.7480 19 | 5/8 M 16 | UCX 09 09-26 09-27 09-28 | FX 09 | 2.50 | 5.50 |
| UCFX 10 10-30 10-31 10-32 | 50 mm 1-7/8 1-15/16 2 | 6-3/8 162 | 5-1/8 130 | 1-23/32 44 | 25/32 20 | 1-1/32 26 | 3/4 19 | 2-11/32 59.4 | 0.8740 22.2 | 5/8 M 16 | UCX 10 10-30 10-31 10-32 | FX 10 | 3.90 | 8.58 |

Four-Bolt Holes Flange Unit

Medium Duty

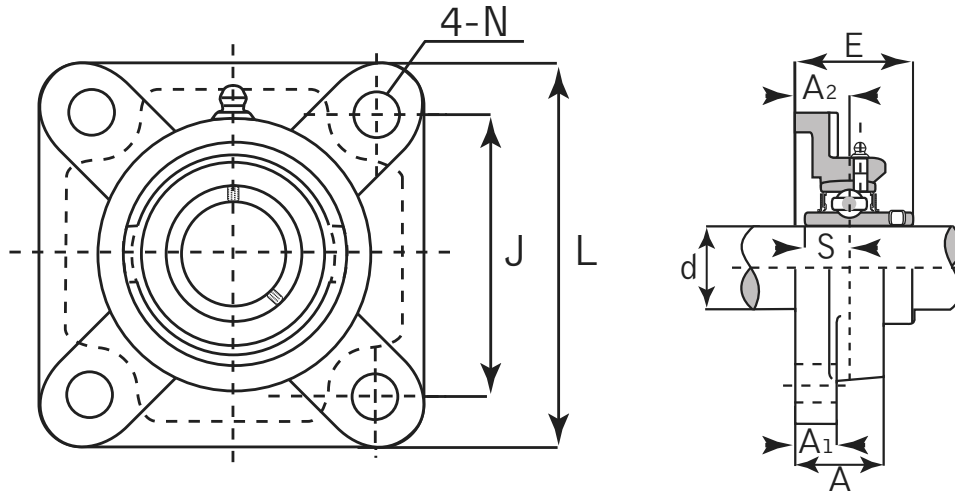

UCFX Set Screw Locking

| Unit No. | Shaft Dia. (inch / mm) | Dimensions (inch / mm) | | | | | | | | Bolt Size | Bearing No. | Housing No. | Weight | |
|---------------------------|---------------------------|------------------------|-----------------------|----------------------|---------------------|----------------------|---------------------|------------------------|-----------------------|-------------|--------------------------|-------------|--------|-------|
| | | d | L | J | A | A1 | A2 | N | E | | | | S | kg |
| UCFX 11 11-35 11-36 | 55 mm 2-3/16 2-1/4 | 6-57/64 175 | 5-5/8 143 | 1-15/16 49 | 25/32 20 | 1-9/64 29 | 3/4 19 | 2-45/64 68.7 | 1.000 25.4 | 5/8 M 16 | UCX 11 11-35 11-36 | FX 11 | 4.90 | 10.78 |
| UCFX 12 12-38 12-39 | 60 mm 2-3/8 2-7/16 | 7-23/64 187 | 5-55/64 149 | 2-5/16 59 | 13/16 21 | 1-11/32 34 | 3/4 19 | 2-29/32 73.7 | 1.000 25.4 | 5/8 M 16 | UCX 12 12-38 12-39 | FX 12 | 5.20 | 11.44 |
| UCFX 13 13-40 | 65 mm 2-1/2 | 7-23/64 187 | 5-55/64 149 | 2-5/16 59 | 13/16 21 | 1-11/32 34 | 3/4 19 | 3-3/32 78.4 | 1.1889 30.2 | 5/8 M 16 | UCX 13 13-40 | FX 13 | 5.30 | 11.66 |
| UCFX 14 14-44 | 70 mm 2-3/4 | 7-3/4 197 | 5-63/64 152 | 2-3/8 60 | 15/16 24 | 1-29/64 37 | 29/32 23 | 3-13/64 81.5 | 1.3110 33.3 | 3/4 M 20 | UCX 14 14-44 | FX 14 | 7.30 | 16.06 |
| UCFX 15 15-47 15-48 | 75 mm 2-15/16 3 | 7-3/4 197 | 5-63/64 152 | 2-11/16 68 | 15/16 24 | 1-37/64 40 | 29/32 23 | 3-33/64 89.3 | 1.3110 33.3 | 3/4 M 20 | UCX 15 15-47 15-48 | FX 15 | 8.10 | 17.82 |
| UCFX 16 16-50 | 80 mm 3-1/8 | 8-7/16 214 | 6-47/64 171 | 2-3/4 70 | 15/16 24 | 1-37/64 40 | 29/32 23 | 3-39/64 91.6 | 1.3425 34.1 | 3/4 M 20 | UCX 16 16-50 | FX 16 | 9.90 | 21.78 |
| UCFX 17 17-52 17-55 | 85 mm 3-1/4 3-7/16 | 8-7/16 214 | 6-47/64 171 | 2-3/4 70 | 15/16 24 | 1-37/64 40 | 29/32 23 | 3-25/32 96.3 | 1.5629 39.7 | 3/4 M 20 | UCX 17 17-52 17-55 | FX 17 | 11.00 | 24.20 |
| UCFX 18 18-56 | 90 mm 3-1/2 | 8-7/16 214 | 6-47/64 171 | 3 76 | 15/16 24 | 1-49/64 45 | 29/32 23 | 4-3/16 106.1 | 1.6889 42.9 | 3/4 M 20 | UCX 18 18-56 | FX 18 | 11.00 | 24.20 |
| UCFX 20 20-63 20-64 | 100 mm 3-15/16 4 | 10-9/16 268 | 8-5/16 211 | 3-13/16 97 | 1-7/32 31 | 2-21/64 59 | 1-7/32 31 | 5-1/64 127.3 | 1.6889 42.9 | 1 M 27 | UCX 20 20-63 20-64 | FX 20 | 17.00 | 28.71 |