

Ball Bearing Inserts

Stainless Steel - SSB & SSA Series

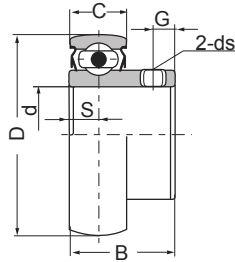

SSB



SSB



SSA

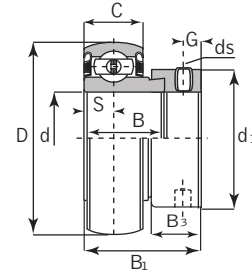

SSA

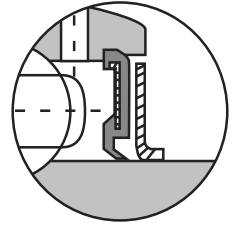

Dual Seal

Unit No.	Shaft Dia. (inch / mm)	Dimensions (inch / mm)						Basic Load Rating lbf / N		Mass	
	d	D	B	C	S	G	ds	Dynamic Cr	Static C0r	kg	lbs
SSB 201 201-8 202 202-10 203	12 mm 1/2 15 mm 5/8 17 mm	1.5748 40	0.866 22	0.472 12	0.236 6	0.177 4.5	1/4-28 M6 X 1	2304 10248	1113 4950	0.10 0.09 0.08 0.08 0.08	0.22 0.20 0.18 0.18 0.18
SSB 204 204-12	20 mm 3/4	1.8504 47	0.984 25	0.551 14	0.275 7	0.177 4.5	1/4-28 M6 X 1	2304 10248	1113 4950	0.13 0.12	0.29 0.26
SSB 205 205-14 205-15 205-16	25 mm 1-1/8 7/8 15/16 1	2.0472 52	1.062 27	0.591 15	0.295 7.5	0.217 5.5	1/4-28 M6 X 1	2522 11216	1324 5888	0.18 0.17 0.17 0.16	0.40 0.37 0.37 0.35
SSB 206 206-18 206-19 206-20	30 mm 1-1/8 1-3/16 1-1/4	2.4409 62	1.181 30	0.630 16	0.315 8	0.217 5.5	1/4-28 M6 X 1	4375 19460	2542 11306	0.25 0.26 0.25 0.23	0.55 0.57 0.55 0.51
SSB 207 207-20 207-21 207-22 207-23	35 mm 1-1/4 1-5/16 1-3/8 1-7/16	2.8346 72	1.2598 32	0.6693 17	0.3346 8.5	0.2362 6	5/16-24 M8 X 1	57706 25670	34394 15.30	0.37 0.41 0.39 0.37 0.35	0.81 0.90 0.86 0.81 0.77
SSB 208 208-24 208-25	40 mm 1-1/2 1-9/16	3.1496 80	1.3386 34	0.7087 18	0.3543 9	0.3150 8	5/16-24 M8 X 1	6636 29520	4078 18140	0.45 0.48 0.45	0.99 1.06 0.99

Other sizes could be available upon request. Minimum quantity may apply. Please refer to page 52 for setscrew maximum torque informations.

Unit No.	Shaft Dia. (inch / mm)	Dimensions (inch / mm)									Basic Load Rating lbf / N		Weight	
	d	D	d1	B	B1	B3	C	S	G	ds	Dynamic Cr	Static C0r	kg	lbs
SSA 201 201-8 202 202-10 203	12 mm 1/2 15 mm 5/8 17 mm	1.5748 40	1.126 28.6	0.7520 19.1	1.126 28.6	0.5315 13.5	0.4724 12	0.2362 6	0.1969 5	1/4-28 UNF M6 x 0.75	2151 9570	1057 4700	0.12 0.14 0.11 0.13 0.10	0.26 0.31 0.24 0.29 0.22
SSA 204 204-12	20 mm 3/4	1.8504 47	1.311 33.3	0.8465 21.5	1.2205 31	0.5315 13.5	0.5512 14	0.2755 7	0.1969 5	1/4-28 UNF M6 x 0.75	2886 12840	1495 6650	0.16 0.15	0.35 0.33
SSA 205 205-14 205-15 205-16	25 mm 7/8 15/16 1	2.0472 52	1.500 38.1	0.8465 21.5	1.2205 31	0.5315 13.5	0.5905 15	0.2953 7.5	0.1969 5	1/4-28 UNF M6 x 0.75	3152 14020	1771 7880	0.21 0.19 0.18 0.18	0.46 0.42 0.40 0.40
SSA 206 206-18 206-19 206-20	30 mm 1-1/8 1-3/16 1-1/4	2.4409 62	1.752 44.5	0.9370 23.8	1.4055 35.7	0.6260 15.9	0.6299 16	0.3150 8	0.2362 6	5/16-24 UNF M8 x 1	4375 19460	2542 11310	0.30 0.30 0.30 0.29	0.66 0.66 0.66 0.64
SSA 207 207-20 207-21 207-22 207-23	35 mm 1-1/4 1-5/16 1-3/8 1-7/16	2.8346 72	2.1890 55.6	1 25.4	1.5315 38.9	0.6890 17.5	0.6693 17	0.3346 8.5	0.2559 6.5	5/16-24 M8 x 1	5771 25670	3439 15300	0.50 0.55 0.53 0.50 0.47	1.102 1.213 1.168 1.036
SSA 208 208-24 208-25	40 mm 1-1/2 1-9/16	3.1496 80	2.3740 60.3	1.1890 30.2	1.7205 43.7	0.7205 18.3	0.7087 18	0.3543 9	0.2559 6.5	5/16-24 M8 x 1	29520 6636	18140 4078	0.63 0.67 0.65	1.389 1.477 1.433