

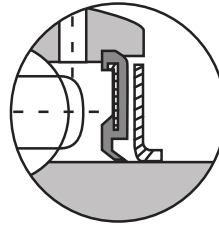

Bearing Insert

Set Screw Series - Medium Duty

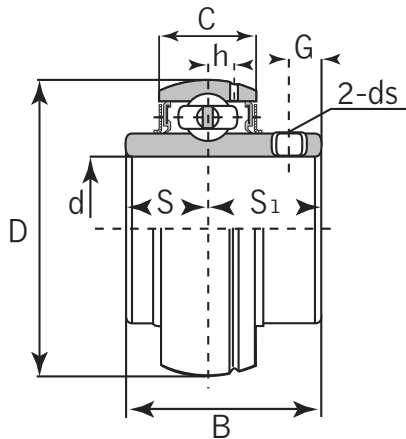

Dual Seal

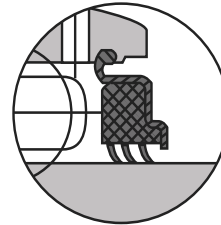

Triple Seal optional

UCX

Unit No.	Shaft Dia. (inch / mm)	Dimensions (inch / mm)								Basic Load Rating lbf / N		Weight		
		d	D	B	C	S	S1	G	h	ds	Dynamic	Static	kg	lbs
UCX 05	25 mm													
05-14	7/8	2.4409	1.5000	0.748	0.626	0.874	0.197	0.197	1/4-28UNF	4384	2540	0.39	0.85	
05-15	15/16	62	38.1	19	15.9	22.2	5	5	M6x1	19500	11300	0.42	0.99	
05-16	1											0.40	0.88	
												0.38	0.83	
UCX 06	30 mm													
06-18	1-1/8	2.8346	1.6890	0.7874	0.689	1.000	0.276	0.224	5/16-24UNF	5778	3440	0.58	1.27	
06-19	1-3/16	72	42.9	20	17.5	25.4	7	5.7	M8x1	25700	15300	0.58	1.27	
06-20	1-1/4											0.55	1.21	
UCX 07	35 mm													
07-21	1-5/16	3.1496	1.9370	0.8268	0.748	1.189	0.315	0.244	5/16-24UNF	6632	4069	0.75	1.65	
07-22	1-3/8	80	49.2	21	19	30.2	8	6.2	M8x1	29500	18100	0.75	1.65	
07-23	1-7/16											0.72	1.58	
UCX 08	40 mm													
08-24	1-1/2	3.3465	1.9370	0.8661	0.748	1.189	0.315	0.252	5/16-24UNF	7104	4631	0.83	1.82	
08-25	1-9/16	85	49.2	22	19	30.2	8	6.5	M8x1	31600	20600	0.87	1.91	
												0.87	1.91	
UCX 09	45 mm													
09-26	1-5/8	3.5433	2.0315	0.9449	0.748	1.283	0.394	0.256	3/8-24UNF	7868	5216	0.95	2.09	
09-27	1-11/16	90	51.6	24	19	32.6	10	6.5	M10x1	35000	23200	1.10	2.42	
09-28	1-3/4											1.01	2.22	
												0.97	2.13	
UCX 10	50 mm													
10-30	1-7/8	3.9370	2.1890	0.9843	0.874	1.315	0.394	0.276	3/8-24UNF	9779	6564	1.29	2.83	
10-31	1-15/16	100	55.6	25	22.2	33.4	10	7.0	M10x1	43500	29200	1.43	3.14	
10-32	2											1.32	2.90	
												1.26	2.77	
UCX 11	55 mm													
11-35	2-3/16	4.3307	2.5630	1.0630	1.000	1.563	0.394	0.299	3/8-24UNF	10723	7396	1.80	3.96	
11-36	2-1/4	110	65.1	27	25.4	39.7	10	7.6	M10x1	47700	32900	1.78	3.91	
												1.70	3.74	

Bearing Insert

Set Screw Series - Medium Duty

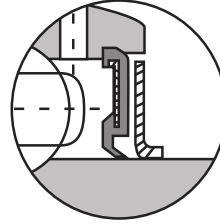
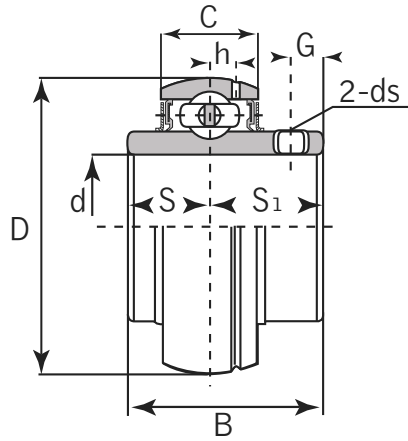

Dual Seal

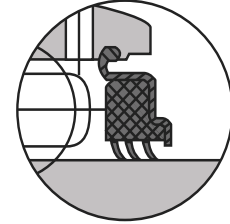

Triple Seal optional

UCX

Unit No.	Shaft Dia. (inch / mm)	Dimensions (inch / mm)								Basic Load Rating lbf / N		Weight	
		d	D	B	C	S	S1	G	h	ds	Dynamic	Static	kg
UCX 12 12-38 12-39	60 mm 2-3/8 2-7/16	4.7244 120	2.5630 65.1	1.1024 28	1.000 25.4	1.5628 39.7	0.394 10	0.335 8.5	3/8-24UNF M10x1	12927 57500	8992 40000	2.05 2.03 1.95	4.51 4.46 4.29
UCX 13 13-40	65 mm 2-1/2	4.9213 125	2.9370 74.6	1.1417 29	1.189 30.2	1.748 44.4	0.472 12	0.350 8.9	1/2-20 UNF M12x1.5	13668 60800	10116 45000	2.52 2.61	5.54 5.74
UCX 14 14-44	70 mm 2-3/4	5.1181 130	3.0630 77.8	1.1811 30	1.311 33.3	1.752 44.5	0.472 12	0.362 9.2	1/2-20 UNF M12x1.5	14837 66000	11128 49500	2.74 2.75	6.02 6.05
UCX 15 15-47 15-48	75 mm 2-15/16 3	5.5118 140	3.2520 82.6	1.2598 32	1.311 33.3	1.9409 49.3	0.472 12	0.374 9.5	1/2-20 UNF M12x1.5	16074 71500	12185 54200	3.41 3.32	7.50 7.30
UCX 16 16-50	80 mm 3-1/8	5.9055 150	3.3740 85.7	1.3386 34	1.343 34.1	3.031 51.6	0.472 12	0.402 10.2	1/2-20UNF M12x1.5	18772 83500	14523 64600	3.87	8.34
UCX 17 17-52 17-55	85 mm 3-1/4 3-7/16	6.2992 160	3.7795 96	1.4173 36	1.5630 39.7	2.217 56.3	0.472 12	0.441 11.2	1/2-20UNF M12x1.5	21582 96000	16074 71500	5.05 4.58	11.11 10.07
UCX 18 18-56	90 mm 3-1/2	6.6929 170	4.0945 104	1.5354 39	1.689 42.9	2.406 61.1	0.630 16	0.492 12.5	9/16-18UNF M14x1.5	24504 109000	18434 82000	6 6.12	13.20 13.46
UCX 20 20-63 20-64	100 mm 3-15/16 3-1/2	7.4803 190	4.6260 117.5	1.6929 43	1.9370 49.2	2.6890 68.3	0.7087 18	0.5994 13.7	5/8X18UNF M16x1.5	29900 133000	23605 105000	8.56 8.33 8.33	18.83 18.32 18.32