

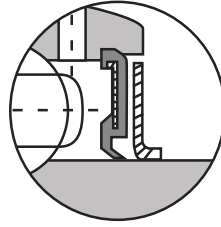

# Bearing Insert

## Set Screw Series - Normal Duty

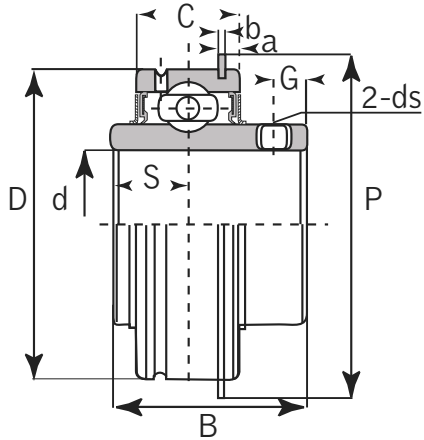

Dual Seal

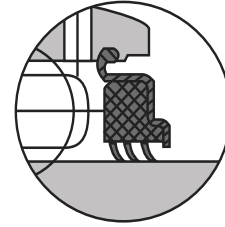

Triple Seal optional

## SER

Unit No.	Shaft Dia. (inch / mm)	Dimensions (inch / mm)									Basic Load Rating lbf / N		Weight		
		d	D	B	b	C	S	a	P	G	ds	Dynamic	Static	kg	lbs
SER 201	12 mm													0.27	0.59
201-8	1/2													0.27	0.59
202	15 mm													0.25	0.55
202-10	5/8	1.8504	1.2205	0.0421	0.6300	0.500	0.0945	2.0748	0.185	1/4-28UNF	2886	1495	0.24	0.53	
203	17 mm	<b>47</b>	<b>31</b>	<b>1.07</b>	<b>16</b>	<b>12.7</b>	<b>2.4</b>	<b>52.7</b>	<b>4.7</b>	M 6 x 0.75	12840	6650	0.23	0.51	
203-11	11/16												0.23	0.51	
204	20 mm												0.20	0.48	
204-12	3/4												0.22	0.48	
SER 205	25 mm													0.21	0.46
205-14	7/8	2.0472	1.3425	0.0421	0.7480	0.5629	0.0945	2.2795	0.2165	1/4-28UNF	3152	1771	0.23	0.51	
205-15	15/16	<b>52</b>	<b>34.1</b>	<b>1.07</b>	<b>19</b>	<b>14.3</b>	<b>2.4</b>	<b>57.9</b>	<b>5.5</b>	M 6 x 0.75	14020	7880	0.22	0.48	
205-16	1												0.20	0.44	
SER 206	30 mm													0.35	0.77
206-18	1-1/8	2.4409	1.5000	0.0649	0.874	0.6260	0.1260	2.6654	0.2165	1/4-28UNF	4375	2542	0.37	0.81	
206-19	1-3/16	<b>62</b>	<b>38.1</b>	<b>1.65</b>	<b>22.2</b>	<b>15.9</b>	<b>3.2</b>	<b>67.7</b>	<b>5.5</b>	M 6 x 0.75	19460	11310	0.35	0.77	
206-20	1-1/4												0.35	0.77	
SER 207	35 mm													0.51	1.12
207-20	1-1/4													0.56	1.23
207-21	1-5/16	2.8346	1.6890	0.0649	0.9449	0.6890	0.1260	3.0906	0.2559	5/16-24UNF	5771	3439	0.54	1.19	
207-22	1-3/8	<b>72</b>	<b>42.9</b>	<b>1.65</b>	<b>24</b>	<b>17.5</b>	<b>3.2</b>	<b>78.4</b>	<b>6.5</b>	M 8 x 1	25670	15300	0.52	1.14	
207-23	1-7/16												0.48	1.06	
SER 208	40 mm													0.68	1.50
208-24	1-1/2	3.1496	1.9370	0.0649	1.1024	0.748	0.1260	3.4094	0.3150	5/16-24UNF	6636	4078	0.72	1.58	
208-25	1-9/16	<b>80</b>	<b>49.2</b>	<b>1.65</b>	<b>28</b>	<b>19</b>	<b>3.2</b>	<b>86.6</b>	<b>8</b>	M 8 x 1	29520	18140	0.68	1.50	

# Bearing Insert Set Screw Series - Normal Duty

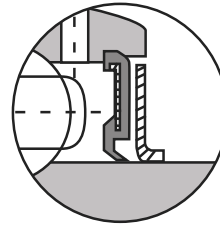
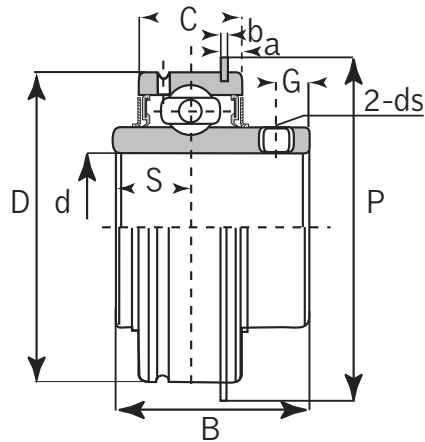

Dual Seal

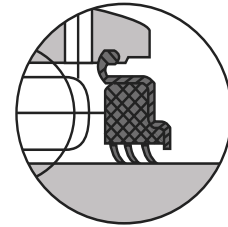

Triple Seal optional

## SER

Unit No.	Shaft Dia. (inch / mm)	Dimensions (inch / mm)									Basic Load Rating lbf / N		Weight	
	d	D	B	b	C	S	a	P	G	ds	Dynamic	Static	kg	lbs
SER 209	45 mm													
209-26	1-5/8	3.3465	1.9370	0.0650	1.1024	0.748	0.1260	3.6063	0.3150	5/16-24UNF	7119	4649	0.90	1.98
209-27	1-11/16	<b>85</b>	<b>49.2</b>	<b>1.65</b>	<b>28</b>	<b>19</b>	<b>3.2</b>	<b>91.6</b>	<b>8</b>	M 8 x 1	31670	20680	0.81	1.78
209-28	1-3/4												0.82	1.80
													0.80	1.76
SER 210	50 mm													
210-30	1-7/8	3.5433	2.0315	0.0949	1.1024	0.7480	0.1260	3.7992	0.3543	3/8-24UNF	7884	5211	0.86	1.89
210-31	1-15/16	<b>90</b>	<b>51.6</b>	<b>2.41</b>	<b>28</b>	<b>19</b>	<b>3.2</b>	<b>96.5</b>	<b>9</b>	M 10 x 1.25	35070	23180	0.92	2.02
210-32	2												0.87	1.91
													0.85	1.87
SER 211	55 mm													
211-32	2	3.9370	2.1890	0.0949	1.1811	0.8740	0.1260	4.1929	0.3543	3/8-24UNF	9752	6569	1.15	2.53
211-34	2-1/8	<b>100</b>	<b>55.6</b>	<b>2.41</b>	<b>30</b>	<b>22.2</b>	<b>3.2</b>	<b>106.5</b>	<b>9</b>	M 10 x 1.25	43380	29222	1.28	2.82
211-35	2-3/16												1.18	2.60
													1.12	2.46
SER 212	60 mm													
212-36	2-1/4	4.3307	2.5630	0.0949	1.2598	1.000	0.1260	4.5960	0.4134	3/8-24UNF	10736	7403	1.58	3.48
212-38	2-3/8	<b>110</b>	<b>65.1</b>	<b>2.41</b>	<b>32</b>	<b>25.4</b>	<b>3.2</b>	<b>116.6</b>	<b>10.5</b>	M 10 x 1.25	47760	32930	1.70	3.74
212-39	2-7/16												1.56	3.56
													1.48	3.26
SER 214	70 mm													
214-43	2-11/16	4.9213	2.7520	0.1091	1.3780	1.0630	0.1575	5.2165	0.4724	7/16-20UNF	13675	10123	2.52	5.54
214-44	2-3/4	<b>125</b>	<b>69.9</b>	<b>2.77</b>	<b>35</b>	<b>27</b>	<b>4</b>	<b>132.5</b>	<b>12</b>	M 12 x 1.5	60830	45030		
SER 215	75 mm													
215-47	2-15/16	5.1181	3.0630	0.1091	1.4961	1.3110	0.1575	5.5000	0.4724	7/16-20UNF	14862	11128	2.89	6.35
215-48	3	<b>130</b>	<b>77.8</b>	<b>2.77</b>	<b>38.0</b>	<b>33.3</b>	<b>4</b>	<b>139.7</b>	<b>12</b>	M 12 x 1.5	66110	49500		
SER 217	85 mm													
217-55	3-7/16	5.9055	3.374	0.1091	1.937	1.3425	0.1900	6.2900	0.5512	7/1620	17680	11600	3.30	7.26
		<b>150</b>	<b>85.7</b>	<b>2.77</b>	<b>49.2</b>	<b>34.1</b>	<b>4.9</b>	<b>159.7</b>	<b>14</b>	M 12 x 1.5	78648	51601		