

Normal Duty

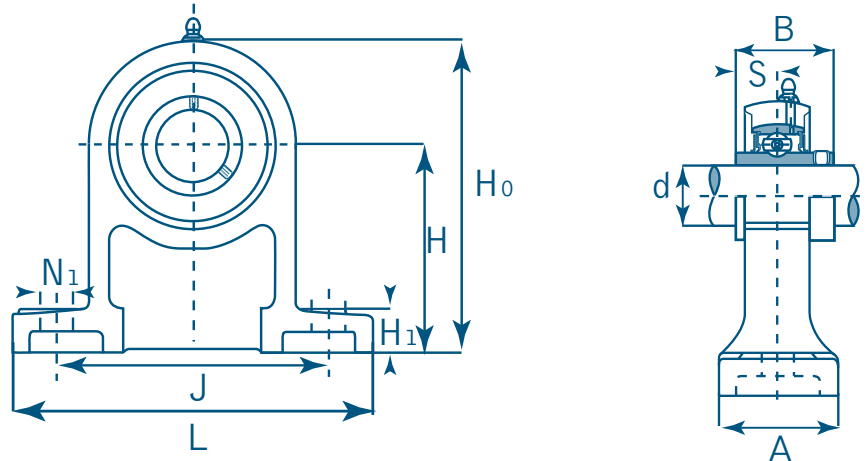

UCPH High Center Height

Unit No.	Shaft Dia. Inch / mm	Dimensions Inch / mm										Bolt Size	Bearing No.	Housing No.	Mass	
		H	H0	H1	L	J	A	N	N1	S	B				kg	lbs
UCPH 201 201-8 202 202-10 203 203-11 204 204-12	12 mm 1/2 15 mm 5/8 17 mm 11/16 20 mm 3/4	2-3/4 70	3-63/64 101	19/32 15	5 127	3-3/4 95	1-9/16 40	1/2 13	3/4 19	0.500 12.7	1.2204 31	3/8 M 10	UC 201 201-8 202 202-10 203 203-11 204 204-12	PH 204	0.81 0.80 0.80 0.80 0.79 0.78 0.77 0.77	1.78 1.76 1.76 1.76 1.74 1.76 1.69 1.69
UCPH 205 205-14 205-15 205-16	25 mm 7/8 15/16 1	3-5/32 80	4-31/64 114	5/8 16	5-1/2 140	4-1/8 105	1-31/32 50	1/2 13	3/4 19	0.5629 14.3	1.3425 34.1	3/8 M 10	UC 205 205-14 205-15 205-16	PH 205	1.01 1.04 1.02 1.01	2.22 2.29 2.24 2.22
UCPH 206 206-17 206-18 206-19 206-20	30 mm 1-1/16 1-1/8 1-3/16 1-1/4	3-35/64 90	5-1/8 130	43/64 17	6-11/32 161	4-3/4 121	1-31/32 50	43/64 17	53/64 21	0.6259 15.9	1.5 38.1	1/2 M 14	UC 206 206-17 206-18 206-19 206-20	PH 206	1.47 1.47 1.49 1.47 1.46	3.23 3.23 3.28 3.23 3.21
UCPH 207 207-20 207-21 207-22 207-23	35 mm 1-1/4 1-5/16 1-3/8 1-7/16	3-47/64 95	5-33/64 140	45/64 18	6-17/32 166	5 127	2-23/64 60	43/64 17	53/64 21	0.6889 17.5	1.6889 42.9	1/2 M 14	UC 207 207-20 207-21 207-22 207-23	PH 207	1.91 1.97 1.97 1.91 1.88	4.20 4.33 4.33 4.20 4.14
UCPH 208 208-24 208-25	40 mm 1-1/2 1-9/16	3-15/16 100	5-29/32 150	3/4 19	7-1/64 178	5-13/32 137	2-3/4 70	43/64 17	53/64 21	0.7480 19	1.9370 49.2	1/2 M 14	UC 208 208-24 208-25	PH 208	2.52 2.56 2.53	5.54 5.63 5.57