

UCHA
Set Screw Locking

Unit No.	Shaft Dia. Inch / mm	Dimensions Inch / mm										Bearing No.	Housing No.	Weight	
		H	H ₀	L	C	A	M	D	F	B	S			kg	lbs
UCHA 201 201-8 202 202-10 203 203-11 204 204-12	12 mm 1/2 15 mm 5/8 17 mm 11/16 20 mm 3/4	2-33/64 64	3-25/32 96	2-33/64 64	0 0	13/16 21	G-3/4	1-37/64 40	3/4 19	1.2204 31	0.500 12.7	UC 201 201-8 202 202-10 203 203-11 204 204-12	HA 204	0.73 0.72 0.72 0.72 0.72 0.71 0.69 0.69	1.61 1.58 1.58 1.58 1.58 1.56 1.52 1.52
UCHA 205 205-14 205-15 205-16	25 mm 7/8 15/16 1	2-33/64 64	4-1/16 103	3-1/16 78	0 0	15/16 24	G-3/4	1-37/64 40	3/4 19	1.3425 34.1	0.5629 14.3	UC 205 205-14 205-15 205-16	HA 205	0.83 0.86 0.84 0.83	1.83 1.89 1.85 1.83
UCHA 206 206-18 206-19 206-20	30 mm 1-1/8 1-3/16 1-1/4	2-33/64 64	4-1/16 103	3-1/16 78	0 0	1-7/64 28	G-3/4	1-37/64 40	3/4 19	1.500 38.1	0.6259 15.9	UC 206 206-18 206-19 206-20	HA 206	0.83 0.85 0.83 0.82	1.83 1.87 1.83 1.80
UCHA 207 207-20 207-21 207-22 207-23	35 mm 1-1/4 1-5/16 1-3/8 1-7/16	2-3/4 70	4-9/16 116	3-5/8 92	0 0	1-3/16 30	G-3/4	1-37/64 40	3/4 19	1.6889 42.9	0.6889 17.5	UC 207 207-20 207-21 207-22 207-23	HA 207	1.16 1.22 1.19 1.16 1.13	2.55 2.68 2.62 2.55 2.49
UCHA 208 208-24 208-25	40 mm 1-1/2 1-9/16	2-7/8 73	4-3/4 121	3-25/32 96	5/64 2	1-5/16 33	G-3/4	1-37/64 40	3/4 19	1.9370 49.2	0.7480 19	UC 208 208-24 208-25	HA 208	1.32 1.36 1.33	2.90 2.99 2.93
UCHA 209 209-26 209-27 209-28	45 mm 1-5/8 1-11/16 1-3/4	3-15/64 82	5-11/32 136	4-1/4 108	13/64 5	1-3/8 35	G-1	1-57/64 48	53/64 21	1.9370 49.2	0.7480 19	UC 209 209-26 209-27 209-28	HA 209	1.92 2.02 1.98 1.94	4.22 4.44 4.36 4.27

Normal Duty

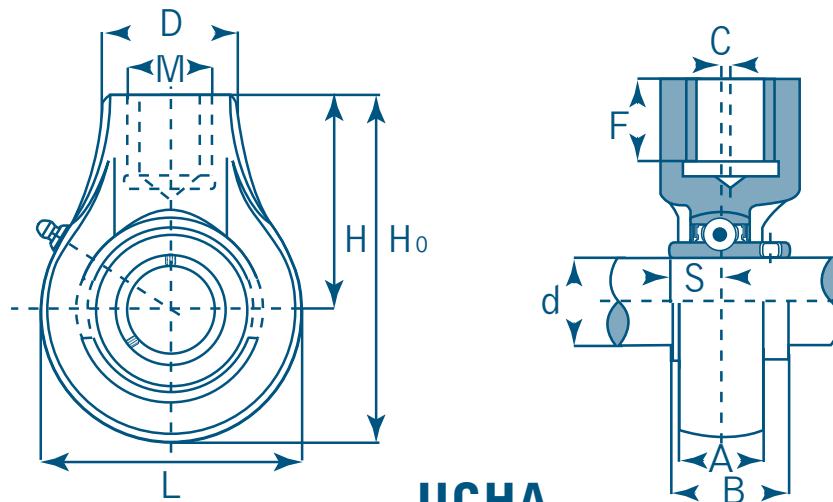

UCHA

Set Screw Locking

Unit No.	Shaft Dia. Inch / mm	Dimensions Inch / mm										Bearing No.	Housing No.	Weight	
		H	H0	L	C	A	M	D	F	B	S			kg	lbs
UCHA 210 210-30 210-31 210-32	50 mm 1-7/8 1-15/16 2	3-17/64 83	5-19/32 142	4-21/32 118	13/64 5	1-29/64 37	G-1	1-57/64 48	53/64 21	2.0314 51.6	0.7480 19	UC 210 210-30 210-31 210-32	HA 210	1.90 1.97 1.92 1.88	4.18 4.33 4.22 4.14
UCHA 211 211-32 211-34 211-35	55 mm 2 2-1/8 2-3/16	3-27/64 87	5-29/32 150	4-31/32 126	9/32 7	1-1/2 38	G-1-1/4	2-23/64 60	63/64 25	2.1889 55.6	0.8740 22.2	UC 211 211-32 211-34 211-35	HA 211	2.16 2.76 2.65 2.59	4.75 6.07 5.83 5.70
UCHA 212 212-36 212-38 212-39	60 mm 2-1/4 2-3/8 2-7/16	4-1/64 102	6-13/16 173	5-19/32 142	23/64 9	1-21/32 42	G-1-1/4	2-23/64 60	1-7/64 28	2.5629 65.1	1.000 25.4	UC 212 212-36 212-38 212-39	HA 212	3.54 3.67 3.52 3.45	7.79 8.07 7.74 7.59
UCHA 213 213-40	65 mm 2-1/2	4-39/64 117	7-7/8 200	6-17/32 166	3/8 9.5	1-47/64 44	G-1-1/2	2-3/4 70	1-17/64 32	2.5629 65.1	1.000 25.4	UC 213 213-40	HA 213	5.80 5.89	12.76 12.96
UCHA 214 214-43 214-44	70 mm 2-11/16 2-3/4	4-39/64 117	7-7/8 200	6-17/32 166	3/8 9.5	1-47/64 44	G-1-1/2	2-3/4 70	1-17/64 32	2.9370 74.6	1.1889 30.2	UC 214 214-43 214-44	HA 214	5.64	12.41
UCHA 215 215-47 215-48	75 mm 2-15/16 3	4-39/64 117	7-7/8 200	6-17/32 166	3/8 9.5	1-47/64 44	G-1-1/2	2-3/4 70	1-17/64 32	3.0629 77.8	1.3110 33.3	UC 215 215-47 215-48	HA 215	5.58	12.28