

SSUCST Series

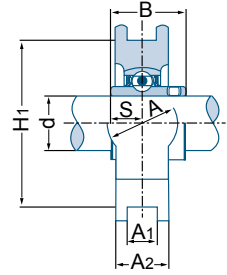

SSUCST 204-12

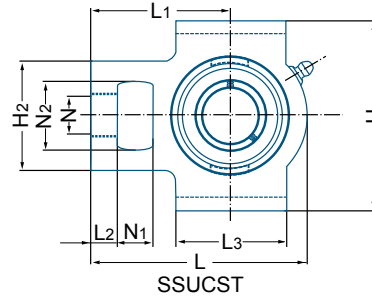

Unit No.	Shaft Dia. d		Dimensions (in) Dimensions (mm)														Bearing No.	Housing No.	Mass	
	in	mm	N1	L2	H2	N2	N	L3	A1	H1	H	L	A	L1	B	S			kg	lbs
SSUCST 201		12															SUC 201			
201-8	1/2		5/8	3/8	2	1-1/4	3/4	2	17/32	3	3-1/2	3-11/16	1-3/8	2-3/8	1-7/32	1/2	201-8			
202		15															202			
202-10	5/8																202-10	SST 204	1,0	2,1
203		17															203			
204-12	3/4		16,0	9,5	51,0	32,0	19,0	51,0	13,5	76,2	88,9	93,5	35,0	60,3	31,0	12,70	204-12			
204		20															204			
SSUCST 205-14	7/8		5/8	3/8	2	1-1/4	3/4	2	17/32	3	3-1/2	3-13/16	1-1/2	2-7/16	1-3/8	9/16	SUC 205-14			
205-15	15/16																205-15			
205		25	16,0	9,5	51,0	32,0	19,0	51,0	13,5	76,2	88,9	97,0	38,0	61,9	34,9	14,29	205	SST 205	1,2	2,6
205-16	1																205-16			
SSUCST 206-18	1-1/8		5/8	3/8	2-3/16	1-7/16	7/8	2-1/4	17/32	3-1/2	4	4-7/16	1-3/4	2-3/4	1-1/2	5/8	SUC 206-18			
206		30															206			
206-19	1-3/16		16,0	9,5	55,5	36,5	22,0	57,0	13,5	88,9	101,6	112,5	44,5	69,9	38,1	15,88	206-19	SST 206	1,5	3,4
206-20	1-1/4																206-20			
SSUCST 207-20	1-1/4		5/8	1/2	2-1/2	1-7/16	7/8	2-1/2	17/32	3-1/2	4	5-1/16	1-3/4	3-1/16	1-11/16	11/16	SUC 207-20			
207-21	1-5/16																207-21			
207-22	1-3/8																207-22			
207		35	16,0	12,5	63,5	36,5	22,0	57,0	13,5	88,9	101,6	128,5	44,5	77,8	42,9	17,46	207	SST 207	1,8	4,0
207-23	1-7/16																207-23			
SSUCST 208-24	1-1/2		3/4	5/8	3-1/4	1-15/16	1-1/8	3-1/4	11/16	4	4-1/2	5-11/16	2-1/8	3-1/2	1-15/16	3/4	SUC 208-24			
208-25	1-9/16																208-25			
208		40	19,0	16,0	82,5	49,0	28,5	82,5	17,5	101,6	114,3	144,5	54,0	88,9	49,2	19,05	208	SST 208	2,7	6,0
SSUCST 209-26	1-5/8		3/4	5/8	3-1/4	1-15/16	1-1/8	3-1/4	11/16	4	4-5/8	5-11/16	2-3/16	3-7/16	1-15/16	3/4	SUC 209-26			
209-27	1-11/16																209-27			
209-28	1-3/4																209-28			
209		45	19,0	16,0	82,5	49,0	28,5	82,5	17,5	101,6	117,5	144,5	55,5	87,3	49,2	19,05	209	SST 209	2,7	6,0
SSUCST 210-30	1-7/8		3/4	5/8	3-1/4	1-15/16	1-1/8	3-3/8	11/16	4	4-5/8	5-7/8	2-3/16	3-9/16	2-1/32	3/4	SUC 210-30			
210-31	1-15/16																210-31			
210		50	19,0	16,0	82,5	49,0	28,5	85,5	17,5	101,6	117,5	149,0	55,5	90,5	51,6	19,05	210	SST 210	2,7	6,0
210-32	2																210-32			

Other sizes could be available upon request. Minimum quantity may apply.
Please refer to page 45 for setscrew maximum torque informations.